

SmartStuff Remote

Item Number: SMREMOTE
Product Specifications



The TCP Smart Remote is a Bluetooth Signal Mesh device that can be used to control any TCP SmartStuff device that is on its Mesh network. Functions such as on/off dimming, and group control can be done through the Smart Remote instead of using the TCP Smart App.

Specifications:

- Operating Voltage2 AAA batteries (not included)
- Network ProtocolBluetooth Signal Mesh
- Wireless Transmit & Receive Frequency 2.4GHz
- Communication Range..... 150 feet

Download TCP SmartStuff App:

The TCP SmartStuff App is used to configure the Bluetooth Signal Mesh and TCP SmartStuff devices. Download the TCP SmartStuff App from the following options:

- Download the SmartStuff App from the Apple App Store or Google Play Store
- Use the QR Codes here:



Instructions for configuring TCP SmartStuff App and SmartStuff devices are at www.tcp.com/smartstuff/

Mounting the Smart Remote to a Wall:

HARDWARE NEEDED

- Electric Drill
- Philips Screw (size needed)
- Drywall Anchor (size needed)
- Ruler
- Pencil

1. Remove the Mounting Base from the Smart Remote.
2. Choose desired location of the Mounting Base.
3. Use a pencil to place a mark on the wall where each Drywall Anchor will go.
4. Drill holes.
5. Place Drywall Anchor in wall.
6. Place Mounting Anchor on wall and screw in.

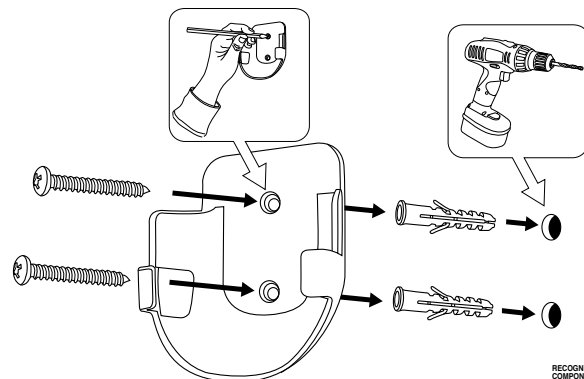

5 YEAR WARRANTY

Dimensions:

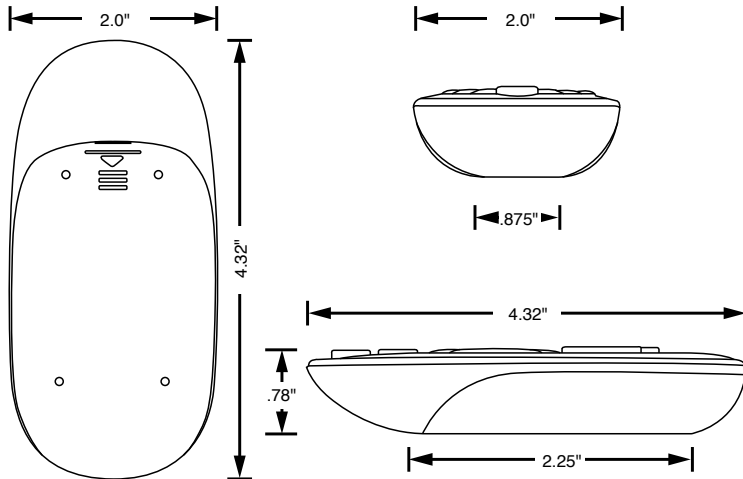

Smart Remote Button Descriptions:

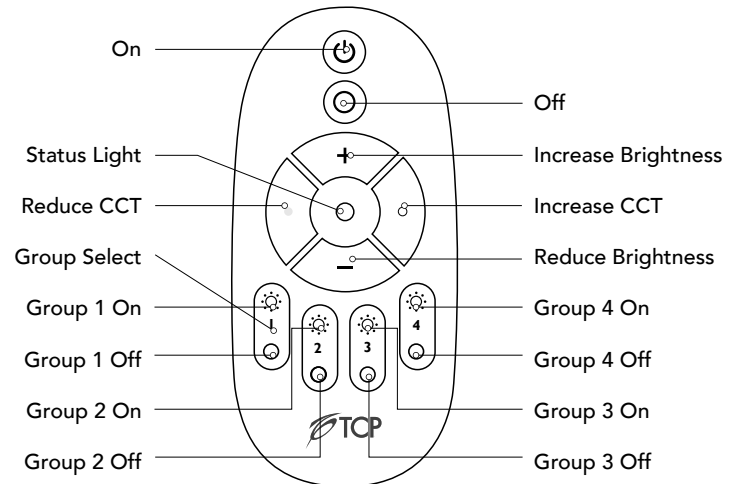

Smart Remote Button Instructions:

ON : Turns on all TCP SmartStuff devices connected to the APP.
OFF : Turns off all TCP SmartStuff devices connected to the APP.

Increase Brightness: Increases the brightness of the TCP SmartStuff devices on a network or an individual group.

Decrease Brightness: Decreases the brightness of the TCP SmartStuff devices on a network or an individual group.

Increase CCT*: Increases the color temperature of the TCP SmartStuff devices on a network or an individual group.

Decrease CCT*: Decreases the color temperature of the TCP SmartStuff devices on a network or an individual group.

* TCP SmartStuff devices must be capable of changing its color temperature for the buttons to work

Group Buttons Group (1, 2, 3, 4)

Group (1, 2, 3, 4) On: Turns on all TCP SmartStuff devices connected to the APP.

Group (1, 2, 3, 4) Off: Turns off all TCP SmartStuff devices connected to the APP.

Group (1, 2, 3, 4) Select: Selects the corresponding group.

Switching Between Groups

Pressing on Group On, Group Off, or Group Select buttons will enable the Smart Remote to control the corresponding group. Pressing the CCT or Brightness buttons will affect the TCP SmartStuff devices in that group only. To change the Smart Remote to control all the SmartStuff devices, press either ON or OFF. Setting up the Groups must be done through the TCP Smart Stuff App.

Resetting the TCP SmartStuff Remote:

With the SmartStuff Remote:

- Press and hold "On" and "Increase Brightness" buttons for 3 seconds.
- The Status Light will slowly flash 3 times
- SmartStuff Remote has been reset to the Factory Setting.

Programming the TCP SmartStuff Remote:

With the SmartStuff Remote:

- Press and hold the "On" and "Reduce Brightness" buttons for 3 seconds.
- The Status Light will flash for 60 seconds.

With the TCP SmartStuff App:

- Go to the Add Accessory Screen.
- The SmartStuff App will scan for nearby SmartStuff Accessories that can be programmed.
- Once the SmartStuff Remote has been found by SmartStuff App, it will show up on the screen.
- Press the "Add Device" button on the SmartStuff App to complete the programming.

TCP SmartStuff Remote can be used to turn on, off and dim all the devices associated with it.